



REUSEABLE PARTICULATE CARTRIDGES DHCS-P2PF



DHCS-P2PF

Description

Dromex® DHCS-P2PF SINGLE UNIFIT reusable, lightweight P2, pre-filter particulate cartridges, used in conjunction with Dromex® SINGLE Unfit particulate filters and Dromex SINGLE cartridge respirator, DH101 filters solid dust and liquid aerosols hazardous which cannot be filtered by the chemical cartridges.

Pre-filters also pro-long the life of the corresponding gas filter by adding additional protection against oil, when working in greasy environments.

Pre-filters are specifically designed for use with the DRO-AIR particulate filter cartridges. The class of the combined filters is as follows:

WITHOUT P2PF		WITH P2PF	
STYLE	CLASS	STYLE	CLASS
DHCS-A1	A1	P2PF+DHCS-A1	A1P2
DHCS-BA	B1	P2PF+DHCS-B1	B1P2
DHCS-K1	K1	P2PF+DHCS-K1	K1P2

Special Instructions

All respiratory equipment should be read in conjunction with BS EN 529:2005 "Respiratory Protective devices – Recommendations for selection, use, care and maintenance".

Do not use these cartridges or enter in area where:

- The Oxygen concentration is not known or is less than 19.5%.
- Contaminants or their concentrations are unknown or are known to be immediately dangerous to life or health. Particulate or gas concentrations exceed levels fixed by the applicable health and safety regulations.
- The requirement for leak tightness is unlikely to be achieved if worn against a beard or facial stubble.
- Not to be used for firefighting.
- Do not use in explosive atmospheres.

These cartridges do not supply oxygen. DO NOT use in oxygen deficient atmospheres (e.g. tanks or other poorly ventilated areas). The lifetime of a filter depends on many factors including the work rate, the air flow and the concentration of the contaminant in the atmosphere.

A particulate filter should be changed immediately when chemical break-through of a contaminant is detected by smell, taste or any other means. A dust filter should be changed when breathing becomes impaired. The UNIFIT TWIN FILTER CARTRIDGE is for use with TWIN filter masks only. DO NOT USE TWIN CARTRIDGES WITH DROMEX SINGLE MASKS. Use genuine DROMEX UNIFIT gas cartridges and particulate pre-filters. None of the materials or processes used in the manufacture of these products are known to be harmful to the wearer. The manufacturer has examined under the system for ensuring quality of production by means of monitoring and inspection. These gas filters are designed to accommodate the basic safety requirements and standards for Personal Protective Equipment. The information contained herein is intended to assist the wearer in the selection of personal protective equipment.

Actual conditions of use cannot be directly simulated in a test environment therefore it is the responsibility of the user and not the manufacturer or supplier to determine the pre-filter suitability for the intended use. All filters should be thoroughly inspected before use to ensure no damage is present. Immediately discard once open inadvertently and if damaged (eg dents).

Changing Filter Cartridge

Remove pre-filter assembly from the filter cartridge. Unclip the pre-filter from the housing and replace with another pre-filter into the housing ensuring that it has clipped in.

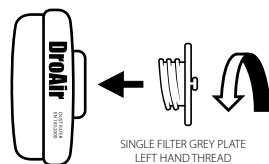

Compliance & Conformity

NRCS Homologated as per SANS 10338:2009 as required by the Occupational Health and Safety Act, 1993 (Act No. 85 of 1993), and the Mine Health and Safety Act, 1996 (Act No. 29 of 1996).

SANS 50143:2003, Respiratory protective devices – Particle filters – Requirements, testing, marking, NRCS Type Approval No.: AZ 2011/49.

Approved for used with half masks as per EN140:1998.

CE EN approval as per BSI CE No. 0086.

Specifications

Style:

Single cartridge,
re-useable P2 pre-filter in a retainer.

Breathing Resistance:

@ 30 l/min, maximum 0.7 mbar,
@ 95.5l/min, maximum 2.4 mbar.

Filter Penetration Maximum:

Sodium Chloride @95l/min is 6%
Paraffin oil @ 95l/min is 6%.

Filter efficiency :

94%.

Additional :

There are no metal fittings in this device.

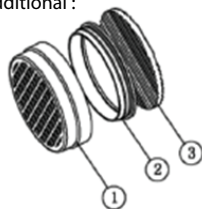

1. White polystyrene filter housing
2. White Linear low density polyethylene
3. P2MB (Met Blow) activated filter

Packaging, Storage & Obsolescence

Packed as one retainer housing with six P2 pre-filters in a polybag, sold as 70 sets in a box.

Store in a cool dry place, away from direct sunlight and contamination. When not in use or during transportation, this filter should be stored in a container such that it is out of direct sunlight, away from chemicals and abrasive substances and cannot be damaged by physical contact with hard surfaces/items.

Filters should be stored at a temperature of +2 > + 55 degree Celsius and at a relative humidity below 75%.



Cleaning & Maintenance

The exterior of the filter can be cleaned with the use of a dry cloth. Solvents must not be used and care should be taken to ensure no water enters the filter.

Shelf life

5 years.

The expiry date of each item is indicated on the cartridge.

Disposal

All industrial waste should be disposed of correctly according to local regulations and good disposal practice. Respiratory protective devices should be disposed of considering the hazardous substances they were used for. Please consider recycling.

Marking

